



FILE NO.:	6040.224
DATE:	January 17, 2007
SUPERSEDES:	6040.224
DATE:	June 1, 2004

BASE MOUNTED PUMP

PARTS LIST

SERIES 4030

**TANGENTIAL DISCHARGE
"S" DESIGNATION**

7/8" IMPELLER BORE -- 1 1/4" MECHANICAL SEAL

OLD DESIGN

NEMA FRAME ASSIGNMENTS

OPEN & TEFC (TEFC FRAMES IN GREY BOX WHERE DIFFERENT THAN OPEN)

NEMA FRAME PROGRAM HP	3600 RPM			1800 RPM			1200 RPM			900 RPM		
	"T" FRAMES	"U" FRAMES	ORIGINAL NEMA FRAMES	"T" FRAMES	"U" FRAMES	ORIGINAL NEMA FRAMES	"T" FRAMES	"U" FRAMES	ORIGINAL NEMA FRAMES	"T" FRAMES	"U" FRAMES	ORIGINAL NEMA FRAMES
	1964	1952		1964	1952		1964	1952		1964	1952	
	-	-	-	143T	182	203	145T	184	204	182T	213	225
1 1/2	143T	182	203	145T	184	204	182T	184	224	184T	213	254
2	145T	184	204	145T	184	224	184T	213	225	213T	215	254
3	145T 182T	184	224	182T	213	225	213T	215	254	215T	254U	284
5	182T 184T	213	225	184	215	254	215T	254U	284	254T	256U	324
7 1/2	184T 213T	215	254	213T	254U	284	254T	256U	324	256T	284U	326
10	213T 215T	254U	284	215T	256U	324	256T	284	326	284T	286U	364
15	215T 254T	256U	324	254T	284T	326	284T	234T	364	286T	326U	365
20	254T 256T	284U 286U	326	256T	286U	364	286T	326U	365	324T	364U	404
25	256T 284TS	286U 324U	364S 365S	284T	324U	364 365	324T	364U	404	326T	365U	405
30	284TS 286TS	324S 326S	364S 404S	286T	326U	365 404	326T	365U	405	364T	404U	444
40	286TS 324TS	326S 364US	365S 405S	324T	364U	404 405	364T	404U	444	365T	405U	445
50	324TS 326TS	364US	404S 444S	326T	365US	405S 444S	365T	405U	445	404T	444U	504U
60	326TS 364TS	365US 405US	405S 445S	364TS	404US 405US	444S 445S	404T	444U	504U	405T	445U	505
75	364TS 365TS	404US 444US	444S 504S	365TS	405US 444US	445S 504S	405T	445U	505	444T	-	-
100	365TS 405TS	405US 445US	445S 505S	404TS 405TS	444US 445US	504S 505S	444T	-	-	445T	-	-
125	404TS 444TS	444US	504US	405TS 444TS	445US	505S	445T	-	-	-	-	-
150	405TS 445TS	445US	505S	444TS 445TS	-	-	-	-	-	-	-	-
200	444TS	-	-	445TS	-	-	-	-	-	-	-	-
250	445TS	-	-	-	-	-	-	-	-	-	-	-

ARMSTRONG

OLD STYLE TANGENTIAL PUMPS CATALOG DESIGNATIONS

"JUNIOR " BEARING FRAME ASSEMBLY

CUSTOM SIZES								
FORMERLY	1524	3/4 AAB			1 AAB	1 1/4 AAB		1 1/2AAB
NEW DESIG.	4000	3/4 B			1B	1 1/4B		1 1/2B
STOCK SIZES								
CUSTOM SIZES		3/4 AAB			1 AAB	1 1/4 AAB		1 1/2AAB
FORMERLY	JR. UNIVERSAL	JU-10	JU-12	-	JU-14	JU-16	JU-18	JU-20
NEW DESIG.	4000	B-80	B-82	-	B-84	B-86	B-88	B-90

"SMALL " AND "MEDIUM" BEARING FRAME PUMPS

CUSTOM SIZES																			
FORMERLY	1510	1 1/4AB	1 1/2AB	2AB	2 1/2A	3A	4AB	1 1/4BB	1 1/2BB	2BB	2 1/2B	3BB	4BB	5BB	6BB	2G	3G	4G	6G
NEW DESIG.	4030	1 1/4D	1 1/2D	2D	2 1/2D	3D	4D	1 1/4E	1 1/2E	2E	2 1/2E	3E	4E	5E	6E	2C	3C	4C	6C
FORMERLY	UNIVERSAL	U1 1/4A	U 1/2A	U2A	U2 1/2A	U3A	U4A	U1 1/4B	U1 1/2B	U2B	U2 1/2B	U3B	U4B	U5B					
NEW DESIG.	4020	1 1/4D	1 1/2D	2D	2 1/2D	3D	4D	1 1/4E	1 1/2E	2E	2 1/2E	3E	4E	5E					
STOCK SIZES (See 4020 Parts List Item 102 Impeller (Stock Sizes) For Impeller Diameters)																			
CUSTOM SIZES		1 1/4D	1 1/2D	2D	2 1/2D	3D	4D	1 1/4E	1 1/2E	2E	2 1/2E	3E	4E	5E					
FORMERLY	UNIVERSAL	-	-	-	U1			-	-	-	U5	-		U8					
		-	-	-	U2	U4	U6	-	-	-	U7	-	U11	U10					
		-	-	-	U3			-	-	-	U9	-		U12					
NEW DESIG.	4020	-	-	-	D141			-	-	-	E145	-		E148					
		-	-	-	D142	D144	D146	-	-	-	E147	-	E151	E150					
		-	-	-	D143			-	-	-	E149	-		E152					

B&G MODEL 1510 --- ARMSTRONG MODEL 4030 BEARING FRAMES, ALL SPEEDS

MOTOR HP AND SPEED	1200RPM	1/2	3/4	1	1 1/2	2	3	5	7 1/2	10	-	-	15	20	-	-	25	30	-
	1800RPM	3/4	1	1 1/2&2	3	5	7 1/2	10	15	20	-	-	25	30	-	60	40	50	75
	3600RPM	-	-	-	5	7 1/2	10	15	20	25	30	40	-	-	50	60	-	-	75
FRAME SIZE	1954 RERATE	56	182	184	213	215	254U	256U	284U	286U	324S	326S	324U	326U	364US	365US	364U	365U	404US
	1964 RERATE	56	143T	145T	182T	184T	213T	215T	254T	256T	284TS	286TS	284T	286T	324TS	326TS	324T	326T	364TS
PUMP SIZE		-	-	-	-	-	-	-	-	-	-	-	-	-	-	364T	-	-	365T
B&G	ARMSTRONG																		
1 1/4A	1 1/4D	S	S	S	S	S	S	S	-	-	-	-	-	-	-	-	-	-	-
1 1/2A	1 1/2D	S	S	S	S	S	S	S	M	M	-	-	-	-	-	-	-	-	-
2A	2D	S	S	S	S	S	S	S	M	M	-	-	-	-	-	-	-	-	-
2 1/2A	2 1/2D	S	S	S	S	S	S	S	M	M	M	M	-	-	-	-	-	-	-
3A	3D	-	S	S	S	S	S	S	M	M	M	M	-	-	-	-	-	-	-
4A	4D	-	S	S	S	S	S	S	M	M	M	M	-	-	-	-	-	-	-
1 1/4BB	1 1/4E	-	S	S	S	S	S	S	M	M	M	M	-	-	-	-	-	-	-
1 1/2BB	1 1/2E	-	S	S	S	S	S	S	M	M	M	M	-	-	-	-	-	-	-
2BB	2E	-	S	S	S	S	S	S	M	M	M	M	-	-	M	M	-	-	-
2 1/2B	2 1/2E	-	-	-	S	S	S	S	-	-	-	-	-	-	-	-	-	-	-
3BB	3E	-	-	-	S	S	S	S	M	-	-	-	-	-	-	-	-	-	-
4BB	4E	-	-	-	-	S	S	S	S	S	-	-	-	-	-	-	-	-	-
5BB	5E	-	-	-	-	-	S	S	S	M	-	-	M	-	-	-	-	-	-
6BB	6E	-	-	-	-	-	-	-	M	M	-	-	M	-	-	-	-	-	-
2C	2G	-	-	-	-	-	M	M	M	M	-	-	-	-	-	-	-	-	-
3C	3G	-	-	-	-	-	M	M	M	M	-	-	-	-	-	-	-	-	-
4C	4G	-	-	-	-	-	M	M	M	M	-	-	M	M	-	-	-	-	-
6C	6G	-	-	-	-	-	-	-	M	M	-	-	M	M	-	M	-	-	M

"S" DESIGNATION - 7/8" IMPELLER BORE, 1 1/4" MECHANICAL SEAL

"M" DESIGNATION - 1 1/4" IMPELLER BORE, 1 5/8" MECHANICAL SEAL

**SERIES 4030 TANGENTIAL, BASE MOUNTED PUMP
"S" SIZE 7/8" IMPELLER BORE -- 1 1/4" MECHANICAL SEAL
EXPLODED VIEW**

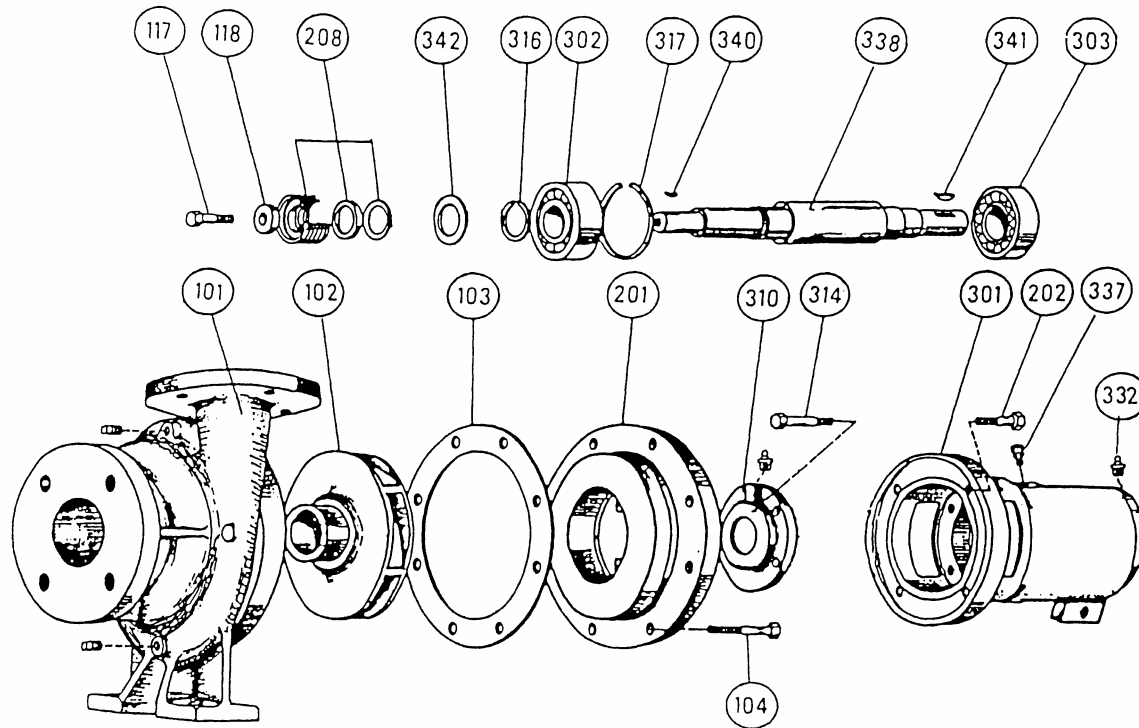

INDEX

ITEM	DESCRIPTION	PAGE	ITEM	DESCRIPTION	PAGE	ITEM	DESCRIPTION	PAGE
**	BRG. FRAME ASSY.	10	202	COVERPLATE CAPSCREW	11	317	SNAP RING (INSIDE)	10
101	VOLUTE	5 & 6	208	MECHANICAL SEAL ASSEMBLY	11	332	GREASE FITTING	10
102	IMPELLER	7 & 8	301	BEARING FRAME	10	337	VENT FITTING	10
103	VOLUTE GASKET	9	302	BALL BEARING (INBOARD)	10	338	SHAFT ASSEMBLY	10
104	VOLUTE CAPSCREW	9	303	BALL BEARING (OUTBOARD)	10	340	IMPELLER KEY	11
117	IMPELLER CAPSCREW	10	310	BEARING COVER (INBOARD)	10	341	COUPLER KEY	11
118	IMPELLER WASHER	11	314	BEARING COVER CAPSCREW	10	342	WATER SLINGER	10
201	COVERPLATE	9	316	SNAP RING (OUTSIDE)	10	**	COUPLER	12

4030 PUMP PARTS

(OLD STYLE TANGENTIAL DISCHARGE)

"S" SIZE 7/8" IMPELLER BORE ----- 1" SHAFT DIAMETER AT COUPLER

1 1/4" MECHANICAL SEAL

ITEM 101 VOLUTE

PUMP SIZE	CONST.	PART NUMBER	BAR CODE
1 1/4D	B.F. & A.I.*	415291-011	
1 1/4D	A.B.*	415291-041	
1 1/2D	B.F. & A.I.*	415293-011	
1 1/2D	A.B.*	415293-041	
2D	B.F. & A.I.*	425141-011	
2D	A.B.*	425141-041	
2 1/2D	B.F. & A.I.*	425143-011	
2 1/2D	A.B.*	425143-041	
3D	B.F. & A.I.*	425145-011	
3D	A.B.*	425145-041	
4D	B.F. & A.I.*	415299-011	
4D	A.B.*	415299-041	

* B.F. Denotes "Bronze Fitted " construction. Parts in contact with pumped liquid are bronze or copper, except volute and cover plate.

A.I. Denotes "All Iron " construction. Parts in contact with the pumped liquid are cast iron or steel, except shaft sleeve & mechanical seal.

A.B. Denotes "All Bronze" construction. Parts in contact with the pumped liquid are bronze or stainless steel.

VOLUTES CONTINUED ON PAGE 6

4030 PUMP PARTS

(OLD STYLE TANGENTIAL DISCHARGE)

"S" SIZE 7/8" IMPELLER BORE ----- 1" SHAFT DIAMETER AT COUPLER

1 1/4" MECHANICAL SEAL

ITEM 101 VOLUTE (cont'd)

PUMP SIZE	CONST.	PART NUMBER	BAR CODE
1 1/4E	B.F. & A.I.*	416168-011	
1 1/4E	A.B.*	416168-041	
1 1/2E	B.F. & A.I.*	425147-011	
1 1/2E	A.B.*	425147-041	
2E	B.F. & A.I.*	419153-011	
2E	A.B.*	419153-041	
2 1/2E	B.F. & A.I.*	415297-011	
2 1/2E	A.B.*	415297-041	
3E	B.F. & A.I.*	416180-011	
3E	A.B.*	416180-041	
4E	B.F. & A.I.*	415301-011	
4E	A.B.*	415301-041	
5E	B.F. & A.I.*	415303-011	
5E	A.B.*	415303-041	

* B.F. Denotes "Bronze Fitted " construction. Parts in contact with pumped liquid are bronze or copper, except volute and cover plate.

A.I. Denotes "All Iron " construction. Parts in contact with the pumped liquid are cast iron or steel, except shaft sleeve & mechanical seal.

A.B. Denotes "All Bronze" construction. Parts in contact with the pumped liquid are bronze or stainless steel.

4030 PUMP PARTS

(OLD STYLE TANGENTIAL DISCHARGE)

"S" SIZE 7/8" IMPELLER BORE ----- 1" SHAFT DIAMETER AT COUPLER

1 1/4" MECHANICAL SEAL

ITEM 102 IMPELLER **

PUMP SIZE	CONST.	PART NUMBER	BAR CODE
1 1/4D	B.F. & AB.*	411852-041	
1 1/4D	A.I.*	411852-011	
1 1/2D	B.F. & AB.*	411860-041	
1 1/2D	A.I.*	411860-011	
2D	B.F. & AB.*	411860-041	
2D	A.I.*	411860-011	
2 1/2D	B.F. & AB.*	406642-041	
2 1/2D	A.I.*	406642-011	
3D	B.F. & AB.*	411868-041	
3D	A.I.*	411868-011	
4D	B.F. & AB.*	411874-041	
4D	A.I.*	411874-011	

NOTES:

* B.F. Denotes "Bronze Fitted " construction. Parts in contact with pumped liquid are bronze or copper, except volute and cover plate.

A.I. Denotes "All Iron " construction. Parts in contact with the pumped liquid are cast iron or steel, except shaft sleeve & mechanical seal.

A.B. Denotes "All Bronze" construction. Parts in contact with the pumped liquid are bronze or stainless steel.

** Impeller Part Numbers are for full or maximum diameter Impellers. Always specify Pump Serial Number and where possible, measure and advise the diameter of the Impeller being replaced on these Pumps.

IMPELLERS CONTINUED ON PAGE 8

4030 PUMP PARTS

(OLD STYLE TANGENTIAL DISCHARGE)

"S" SIZE 7/8" IMPELLER BORE ----- 1" SHAFT DIAMETER AT COUPLER

1 1/4" MECHANICAL SEAL

ITEM 102 IMPELLER ** (cont'd)

PUMP SIZE	CONST.	PART NUMBER	BAR CODE
1 1/4E	B.F. & AB.*	407922-041	
1 1/4E	A.I.*	407922-011	
1 1/2E	B.F. & AB.*	407922-041	
1 1/2E	A.I.*	407922-011	
2E	B.F. & AB.*	411881-041	
2E	A.I.*	411881-011	
2 1/2E	B.F. & AB.*	411881-041	
2 1/2E	A.I.*	411881-011	
3E	B.F. & AB.*	419465-041	
3E	A.I.*	419465-011	
4E	B.F. & AB.*	411940-041	
4E	A.I.*	411940-011	
5E	B.F. & AB.*	411941-041	
5E	A.I.*	411941-011	

NOTES:

* B.F. Denotes "Bronze Fitted " construction. Parts in contact with pumped liquid are bronze or copper, except volute and cover plate.

A.I. Denotes "All Iron " construction. Parts in contact with the pumped liquid are cast iron or steel, except shaft sleeve & mechanical seal.

A.B. Denotes "All Bronze" construction. Parts in contact with the pumped liquid are bronze or stainless steel.

** Impeller Part Numbers are for full or maximum diameter Impellers. Always specify Pump Serial Number and where possible, measure and advise the diameter of the Impeller being replaced on these Pumps.

4030 PUMP PARTS

(OLD STYLE TANGENTIAL DISCHARGE)

"S" SIZE 7/8" IMPELLER BORE----- 1" SHAFT DIAMETER AT COUPLER

1 1/4" MECHANICAL SEAL

ITEM 201 COVERPLATE

PUMP SIZE	CONST.	PART NUMBER	BAR CODE
1 1/4D TO 4D	B.F. & A.I.*	409564-011	
1 1/4D TO 4D	A.B.*	409564-041	
1 1/4E TO 5E	B.F. & A.I.*	409563-011	
1 1/4E TO 5E	A.B.*	409563-041	

ITEM 103 VOLUTE GASKET

PUMP SIZE	CONST.	PART NUMBER	BAR CODE
1 1/4D TO 4D	ALL	106592-000	
1 1/4E TO 5E	ALL	406604-000	

ITEM 104 VOLUTE CAPSCREW

PUMP SIZE	CONST.	PART NUMBER	BAR CODE
1 1/4D TO 4D	ALL	8 REQ'D 911121-108 3/8-16NCX7/8"	
1 1/4E TO 5E	ALL	12 REQ'D 911123-108 7/16-14NCX1"	

NOTES:

* B.F. Denotes "Bronze Fitted " construction. Parts in contact with pumped liquid are bronze or copper, except volute and cover plate.

A.I. Denotes "All Iron " construction. Parts in contact with the pumped liquid are cast iron or steel, except shaft sleeve & mechanical seal.

A.B. Denotes "All Bronze" construction. Parts in contact with the pumped liquid are bronze or stainless steel.

4030 PUMP PARTS

(OLD STYLE TANGENTIAL DISCHARGE)

"S" SIZE 7/8" IMPELLER BORE ---- 1" SHAFT DIAMETER AT COUPLER

1 1/4" MECHANICAL SEAL

BEARING FRAME ASSEMBLY

ITEM NUMBER	DESCRIPTION	PART NUMBER	BAR CODE
not shown	BEARING FRAME ASSY. BF & IF	819359-002	
not shown	BEARING FRAME ASSY. AB	819360-002	
NOTE: Each Bearing Frame Assembly includes components in this table having a part number listed in the column below the Bearing Frame Part Number.			
117	IMPELLER CAPSCREW S/S	911900-114	
301	BEARING FRAME	419207-002	
302	BALL BEARING (INBOARD)	871101-683	
303	BALL BEARING (OUTBOARD)	871101-363	
310	BEARING COVER (INBOARD)	419208-002	
316	SNAP RING (OUTSIDE)	923109-008	
317	SNAP RING (INSIDE)	923110-031	
332	GREASE FITTING	425030-011	
337	VENT FITTING	407444-000	
338	SHAFT AND SLEEVE ASSY. BF & AI*	819364-000	
338	SHAFT AND SLEEVE ASSY. AB*	819365-000	
342	WATER SLINGER	406622-000	

NOTES:

* B.F. Denotes "Bronze Fitted " construction. Parts in contact with pumped liquid are bronze or copper, except volute and cover plate.

A.I. Denotes "All Iron" construction. Parts in contact with the pumped liquid are cast iron or steel, except shaft sleeve & mechanical seal.

A.B. Denotes "All Bronze" construction. Parts in contact with the pumped liquid are bronze or stainless steel.

" FOR COMMON PARTS AND HARDWARE SEE PAGE 11 "

4030 PUMP PARTS

(OLD STYLE TANGENTIAL DISCHARGE)

"S" SIZE 7/8" IMPELLER BORE ---- 1" SHAFT DIAMETER AT COUPLER

1 1/4" MECHANICAL SEAL

COMMON PARTS

(Not included in the Bearing Frame Assembly)

ITEM NUMBER	DESCRIPTION	PART NUMBER	BAR CODE
118	IMPELLER WASHER BF& IF*	406614-000	
118	IMPELLER WASHER AB*	406677-000	
208	SEAL ASSEMBLY (Std.) BF/AB/IF*	825458-001	
208	SEAL ASSEMBLY -- (Viton) BF/AB/AI*	825458-003	

HARDWARE

ITEM NUMBER	DESCRIPTION	PART NUMBER	BAR CODE
202	COVERPLATE CAPSCREW (4 REQ'D)	911121-108	
308	BRG. COVER CAPSCREW (4 REQ'D)	911121-107	
340	IMPELLER KEY	974515-100	
341	COUPLER KEY	974523-100	

NOTES:

* B.F. Denotes "Bronze Fitted " construction. Parts in contact with pumped liquid are bronze or copper, except volute and cover plate.

A.I. Denotes "All Iron" construction. Parts in contact with the pumped liquid are cast iron or steel, except shaft sleeve & mechanical seal.

A.B. Denotes "All Bronze" construction. Parts in contact with the pumped liquid are bronze or stainless steel.

4030 PUMP PARTS

(OLD STYLE TANGENTIAL DISCHARGE)

"S" SIZE 7/8" IMPELLER BORE ---- 1" SHAFT DIAMETER AT COUPLER

1 1/4" MECHANICAL SEAL

COUPLER SELECTION TABLE

(WOODS TYPE)

PUMP SHAFT SIZE	MOTOR FRAME SIZE	MOTOR SHAFT SIZE	WOODS SIZE	COUPLER PART NUMBER	BAR CODE
1"	56	5/8"	4J	819340-002	
1"	143T - 145T 182 - 184	7/8"	4J	819341-002	
1"	182T - 184T 213 - 215	1 1/8"	5J	819342-002	
1"	213T - 215T 254U - 256U	1 3/8"	6J	819344-002	
1"	254T - 256T 284U	1 5/8"	7J	819347-002	

COUPLER INSERT SELECTION TABLE

(WOODS TYPE)

COUPLER INSERT SIZE	INSERT NUMBER	PART NUMBER	BAR CODE
4J	4JE	875000-801	
5J	5JE	875000-802	
6J	6JE	875000-803	
7J	7JE	875000-804	