



FILE NO.:	6040.232
DATE:	June 1, 1996
SUPERSEDES:	New
DATE:	New

## PARTS LIST

---

# SERIES 4040

BASE MOUNTED PUMP  
DOUBLE MECHANICAL SEAL DESIGN

TANGENTIAL DISCHARGE  
"S" DESIGNATION

7/8" IMPELLER BORE -- 1-1/4" MECHANICAL SEAL

**OLD DESIGN**



**SERIES 4040 BEARING FRAMES, ALL SPEEDS**

MOTOR HP	1200RPM	1/2	3/4	1	1 1/2	2	3	5	7 1/2	10	-	-	15	20	-	-	25	30	-	
	AND	1800RPM	3/4	1	1 1/2&2	3	5	7 1/2	10	15	20	-	-	25	30	-	-	40	50	-
	SPEED	3600RPM	-	-	-	5	7 1/2	10	15	20	25	30	40	-	-	50	60	-	-	75
FRAME SIZE	1954 RERATE	56	182	184	213	215	254U	256U	284U	286U	324S	326S	324U	326U	364US	365US	364U	365U	404US	
	1964 RERATE	56	143T	145T	182T	184T	213T	215T	254T	256T	284TS	286TS	284T	286T	324TS	326TS	324T	326T	364TS	
PUMP SIZE																				
B&G	ARMSTRONG																			
1 1/4A	1 1/4D	S	S	S	S	S	S	S	-	-	-	-	-	-	-	-	-	-	-	-
1 1/2A	1 1/2D	S	S	S	S	S	S	S	M	M	-	-	-	-	-	-	-	-	-	-
2A	2D	S	S	S	S	S	S	S	M	M	-	-	-	-	-	-	-	-	-	-
2 1/2A	2 1/2D	S	S	S	S	S	S	S	M	M	M	M	-	-	-	-	-	-	-	-
3A	3D	-	S	S	S	S	S	S	M	M	M	M	-	-	-	-	-	-	-	-
4A	4D	-	S	S	S	S	S	S	M	M	M	M	-	-	-	-	-	-	-	-
1 1/4BB	1 1/4E	-	S	S	S	S	S	S	M	M	M	M	-	-	-	-	-	-	-	-
1 1/2BB	1 1/2E	-	S	S	S	S	S	S	M	M	M	M	-	-	-	-	-	-	-	-
2BB	2E	-	S	S	S	S	S	S	M	M	M	M	-	-	M	M	-	-	-	-
2 1/2B	2 1/2E	-	-	-	S	S	S	S	-	-	-	-	-	-	-	-	-	-	-	-
3BB	3E	-	-	-	S	S	S	S	M	-	-	-	-	-	-	-	-	-	-	-
4BB	4E	-	-	-	-	S	S	S	M	M	-	-	-	-	-	-	-	-	-	-
5BB	5E	-	-	-	-	-	S	S	M	M	-	-	M	-	-	-	-	-	-	-
6BB	6E	-	-	-	-	-	-	-	M	M	-	-	M	-	-	-	-	-	-	-

"S" DESIGNATION - 7/8" IMPELLER BORE, DOUBLE 1 1/4" MECHANICAL SEAL

"M" DESIGNATION - 1 1/4" IMPELLER BORE, DOUBLE 1 5/8" MECHANICAL SEAL

**SERIES 4040 TANGENTIAL, BASE MOUNTED PUMP**  
**"S" SIZE 7/8" IMPELLER BORE -- DOUBLE 1 1/4" MECHANICAL SEAL**  
**SECTIONAL DRAWING**

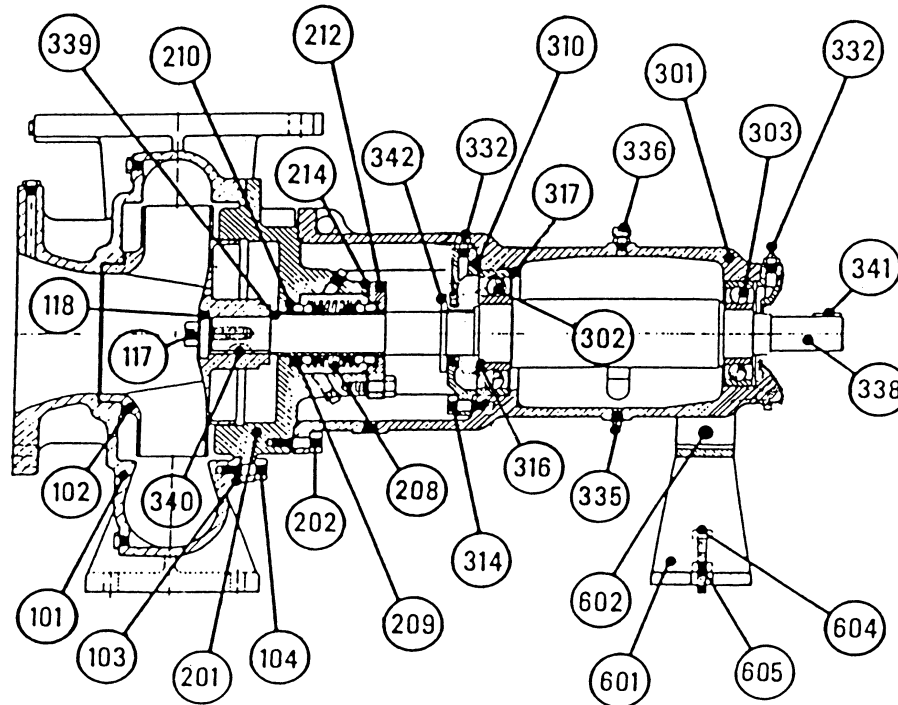

**INDEX**

ITEM	DESCRIPTION	PAGE	ITEM	DESCRIPTION	PAGE	ITEM	DESCRIPTION	PAGE
**	BRG. FRAME ASSY.	9	212	SEAL PLATE	10	317	SNAP RING (OUTSIDE)	9
101	VOLUTE	3 & 4	213	SEAL PLATE CAPSCREWS	10	332	GREASE FITTING	9
102	IMPELLER	5 & 6	214	SEAL PLATE GASKET	10	337	VENT FITTING	9
103	VOLUTE GASKET	7	215	SEAL CHAMBER BUSHING	10	338	SHAFT ASSEMBLY	9
104	VOLUTE CAPSCREW	8	301	BEARING FRAME	9	340	IMPELLER KEY	10
117	IMPELLER CAPSCREW	9	302	BALL BEARING (INBOARD)	9	341	COUPLER KEY	10
118	IMPELLER WASHER	10	303	BALL BEARING (OUTBOARD)	9	342	WATER SLINGER	9
201	COVERPLATE	10	310	BEARING COVER (INBOARD)	9		COUPLER	11
202	COVERPLATE CAPSCREW	10	314	BEARING COVER CAPSCREW	9			
208	MECHANICAL SEAL ASSEMBLY	10	316	SNAP RING (INSIDE)	9			

# 4040 PUMP PARTS

( OLD STYLE TANGENTIAL DISCHARGE )

"S" SIZE 7/8" IMPELLER BORE ----- 1" SHAFT DIAMETER AT COUPLER

DOUBLE 1 1/4" MECHANICAL SEAL

<b>ITEM 101 VOLUTE</b>			
<b>PUMP SIZE</b>	<b>CONST.</b>	<b>PART NUMBER</b>	<b>BAR CODE</b>
1 1/4D	B.F. & A.I.*	415291-011	
1 1/4D	A.B.*	415291-041	
1 1/2D	B.F. & A.I.*	415293-011	
1 1/2D	A.B.*	415293-041	
2D	B.F. & A.I.*	425141-011	
2D	A.B.*	425141-041	
2 1/2D	B.F. & A.I.*	425143-011	
2 1/2D	A.B.*	425143-041	
3D	B.F. & A.I.*	425145-011	
3D	A.B.*	425145-041	
4D	B.F. & A.I.*	415299-011	
4D	A.B.*	415299-041	

\* B.F. Denotes "Bronze Fitted " construction. Parts in contact with pumped liquid are bronze or copper, except volute and cover plate.

A.I. Denotes "All Iron " construction. Parts in contact with the pumped liquid are cast iron or steel, except shaft sleeve & mechanical seal.

A.B. Denotes "All Bronze" construction. Parts in contact with the pumped liquid are bronze or stainless steel.

**VOLUTES CONTINUED ON PAGE 4**

# 4040 PUMP PARTS

( OLD STYLE TANGENTIAL DISCHARGE )

"S" SIZE 7/8" IMPELLER BORE ----- 1" SHAFT DIAMETER AT COUPLER

DOUBLE 1 1/4" MECHANICAL SEAL

ITEM 101 VOLUTE ( cont'd )			
PUMP SIZE	CONST.	PART NUMBER	BAR CODE
1 1/4E	B.F. & A.I.*	416168-011	
1 1/4E	A.B.*	416168-041	
1 1/2E	B.F. & A.I.*	425147-011	
1 1/2E	A.B.*	425147-041	
2E	B.F. & A.I.*	419153-011	
2E	A.B.*	419153-041	
2 1/2E	B.F. & A.I.*	415297-011	
2 1/2E	A.B.*	415297-041	
3E	B.F. & A.I.*	416180-011	
3E	A.B.*	416180-041	
4E	B.F. & A.I.*	415301-011	
4E	A.B.*	415301-041	
5E	B.F. & A.I.*	415303-011	
5E	A.B.*	415303-041	

\* B.F. Denotes "Bronze Fitted " construction. Parts in contact with pumped liquid are bronze or copper, except volute and cover plate.

A.I. Denotes "All Iron " construction. Parts in contact with the pumped liquid are cast iron or steel, except shaft sleeve & mechanical seal.

A.B. Denotes "All Bronze" construction. Parts in contact with the pumped liquid are bronze or stainless steel.

# 4040 PUMP PARTS

( OLD STYLE TANGENTIAL DISCHARGE )

"S" SIZE 7/8" IMPELLER BORE ----- 1" SHAFT DIAMETER AT COUPLER

DOUBLE 1 1/4" MECHANICAL SEAL

ITEM 102 IMPELLER **			
PUMP SIZE	CONST.	PART NUMBER	BAR CODE
1 1/4D	B.F. & AB.*	411852-041	
1 1/4D	A.I.*	411852-011	
1 1/2D	B.F. & AB.*	411860-041	
1 1/2D	A.I.*	411860-011	
2D	B.F. & AB.*	411860-041	
2D	A.I.*	411860-011	
2 1/2D	B.F. & AB.*	406642-041	
2 1/2D	A.I.*	406642-011	
3D	B.F. & AB.*	411868-041	
3D	A.I.*	411868-011	
4D	B.F. & AB.*	411874-041	
4D	A.I.*	411874-011	

**NOTES:**

\* B.F. Denotes "Bronze Fitted " construction. Parts in contact with pumped liquid are bronze or copper, except volute and cover plate.

A.I. Denotes "All Iron " construction. Parts in contact with the pumped liquid are cast iron or steel, except shaft sleeve & mechanical seal.

A.B. Denotes "All Bronze" construction. Parts in contact with the pumped liquid are bronze or stainless steel.

\*\* Impeller Part Numbers are for full or maximum diameter Impellers. Always specify Pump Serial Number and where possible, measure and advise the diameter of the Impeller being replaced on these Pumps.

IMPELLERS CONTINUED ON PAGE 6

# 4040 PUMP PARTS

( OLD STYLE TANGENTIAL DISCHARGE )

"S" SIZE 7/8" IMPELLER BORE ----- 1" SHAFT DIAMETER AT COUPLER

DOUBLE 1 1/4" MECHANICAL SEAL

<b>ITEM 102 IMPELLER ** ( cont'd )</b>			
<b>PUMP SIZE</b>	<b>CONST.</b>	<b>PART NUMBER</b>	<b>BAR CODE</b>
1 1/4E	B.F. & AB.*	407922-041	
1 1/4E	A.I.*	407922-011	
1 1/2E	B.F. & AB.*	407922-041	
1 1/2E	A.I.*	407922-011	
2E	B.F. & AB.*	411881-041	
2E	A.I.*	411881-011	
2 1/2E	B.F. & AB.*	411881-041	
2 1/2E	A.I.*	411881-011	
3E	B.F. & AB.*	419465-041	
3E	A.I.*	419465-011	
4E	B.F. & AB.*	411940-041	
4E	A.I.*	411940-011	
5E	B.F. & AB.*	411941-041	
5E	A.I.*	411941-011	

**NOTES:**

\* B.F. Denotes "Bronze Fitted " construction. Parts in contact with pumped liquid are bronze or copper, except volute and cover plate.

A.I. Denotes "All Iron " construction. Parts in contact with the pumped liquid are cast iron or steel, except shaft sleeve & mechanical seal.

A.B. Denotes "All Bronze" construction. Parts in contact with the pumped liquid are bronze or stainless steel.

\*\* Impeller Part Numbers are for full or maximum diameter Impellers. Always specify Pump Serial Number and where possible, measure and advise the diameter of the Impeller being replaced on these Pumps.



# 4040 PUMP PARTS

( OLD STYLE TANGENTIAL DISCHARGE )

"S" SIZE 7/8" IMPELLER BORE ----- 1" SHAFT DIAMETER AT COUPLER

DOUBLE 1 1/4" MECHANICAL SEAL

ITEM 201 COVERPLATE			
PUMP SIZE	CONSTRUCTION	PART NUMBER	BAR CODE
1 1/4D TO 4D	B.F. & A.I.*	425184-011	
1 1/4D TO 4D	A.B.*	425184-041	
1 1/4E TO 5E	B.F. & A.I.*	425185-011	
1 1/4E TO 5E	A.B.*	425185-041	

ITEM 103 VOLUTE GASKET			
PUMP SIZE	CONSTRUCTION	PART NUMBER	BAR CODE
1 1/4D TO 4D	ALL	106592-000	
1 1/4E TO 5E	ALL	406604-000	

ITEM 104 VOLUTE CAPSCREW					
PUMP SIZE	CONST.	NO. REQ'D.	SIZE	PART NUMBER	BAR CODE
1 1/4D TO 4D	ALL	8	3/8-16NCX7/8"	911121-108	
1 1/4E TO 5E	ALL	12	7/16-14NCX1"	911123-108	

**NOTES:**

\* B.F. Denotes "Bronze Fitted " construction. Parts in contact with pumped liquid are bronze or copper, except volute and cover plate.

A.I. Denotes "All Iron " construction. Parts in contact with the pumped liquid are cast iron or steel, except shaft sleeve & mechanical seal.

A.B. Denotes "All Bronze" construction. Parts in contact with the pumped liquid are bronze or stainless steel.

# 4040 PUMP PARTS

( OLD STYLE TANGENTIAL DISCHARGE )

"S" SIZE 7/8" IMPELLER BORE ----- 1" SHAFT DIAMETER AT COUPLER  
DOUBLE 1 1/4" MECHANICAL SEAL

<b>BEARING FRAME ASSEMBLY</b>			
ITEM NUMBER	DESCRIPTION	PART NUMBER	BAR CODE
	BEARING FRAME ASSY.                      B.F. & A.I.*	819473-012	
	BEARING FRAME ASSY.                      A.B.	819473-042	
<p><b>NOTE:</b> Each Bearing Frame Assembly includes components in this table having a part number listed in the column below the Bearing Frame Part Number.</p>			
117	IMPELLER CAPSCREW S/S	911900-108	
301	BEARING FRAME	419455-012	
302	BALL BEARING ( INBOARD )	871101-683	
303	BALL BEARING ( OUTBOARD )	871101-363	
310	BEARING COVER (INBOARD)	419208-002	
316	SNAP RING (INSIDE)	923110-031	
317	SNAP RING (OUTSIDE)	923109-008	
332	GREASE FITTING	425030-011	
337	VENT FITTING	407444-000	
338	SHAFT ASSEMBLY                              B.F. & A.I.*	819471-011	
338	SHAFT ASSEMBLY                              A.B.*	819471-071	
342	WATER SLINGER	406622-000	

**NOTES:**

\* B.F. Denotes "Bronze Fitted " construction. Parts in contact with pumped liquid are bronze or copper, except volute and cover plate.

A.I. Denotes "All Iron" construction. Parts in contact with the pumped liquid are cast iron or steel, except shaft sleeve.

A.B. Denotes "All Bronze" construction. Parts in contact with the pumped liquid are bronze or stainless steel.

**FOR COMMON PARTS SEE PAGE 9**

# 4040 PUMP PARTS

( OLD STYLE TANGENTIAL DISCHARGE )

"S" SIZE 7/8" IMPELLER BORE ----- 1" SHAFT DIAMETER AT COUPLER

DOUBLE 1 1/4" MECHANICAL SEAL

<b>COMMON PARTS</b>			
( Not included in the Bearing Frame Assembly )			
ITEM NUMBER	DESCRIPTION	PART NUMBER	BAR CODE
118	IMPELLER WASHER B.F.& A.I.*	406614-000	
118	IMPELLER WASHER A.B.*	406677-000	
208	MECHANICAL SEAL ASSEMBLY B.F.&A.B.	806616-022	
208	MECHANICAL SEAL ASSEMBLY A.I.	806676-022	
212	SEAL PLATE B.F.&A.B.	425181-041	
212	SEAL PLATE A.I.	425181-011	
213	SEAL PLATE CAPSCREW ( 4 REQ'D)	911121-108	
214	SEAL PLATE GASKET	205142-002	
215	SEAL CHAMBER BUSHING B.F.&A.B.	425182-041	
215	SEAL CHAMBER BUSHING A.I.	425182-011	
338	SHAFT SLEEVE B.F.	419472-041	
338	SHAFT SLEEVE A.B.& A.I.	419472-071	

<b>HARDWARE</b>			
ITEM NUMBER	DESCRIPTION	PART NUMBER	ARMSTRONG BAR CODE
202	COVERPLATE CAPSCREW (4 REQ'D)	911121-108	
314	BEARING COVER CAPSCREW (4 REQ'D)	911121-107	
340	IMPELLER KEY	974515-100	
341	COUPLER KEY	974523-100	

**NOTES:**

\* B.F. Denotes "Bronze Fitted " construction. Parts in contact with pumped liquid are bronze or copper, except volute and cover plate.

A.I. Denotes "All Iron" construction. Parts in contact with the pumped liquid are cast iron or steel, except shaft sleeve & mechanical seal.

A.B. Denotes "All Bronze" construction. Parts in contact with the pumped liquid are bronze or stainless steel.

# 4040 PUMP PARTS

(OLD STYLE TANGENTIAL DISCHARGE)

"S" SIZE 7/8" IMPELLER BORE ---- 1" SHAFT DIAMETER AT COUPLER

DOUBLE 1 1/4" MECHANICAL SEAL

## COUPLER SELECTION TABLE

( WOODS TYPE )

PUMP SHAFT SIZE	MOTOR FRAME SIZE	MOTOR SHAFT SIZE	WOODS SIZE	COUPLER PART NUMBER	BAR CODE
1"	56	5/8"	4J	819340-002	
1"	143T - 145T 182 - 184	7/8"	4J	819341-002	
1"	182T - 184T 213 - 215	1 1/8"	5J	819342-002	
1"	213T - 215T 254U - 256U	1 3/8"	6J	819344-002	
1"	254T - 256T 284U	1 5/8"	7J	819347-002	

## COUPLER INSERT SELECTION TABLE

( WOODS TYPE )

COUPLER INSERT SIZE	INSERT NUMBER	PART NUMBER	BAR CODE
4J	4JE	875000-801	
5J	5JE	875000-802	
6J	6JE	875000-803	
7J	7JE	875000-804	