

File No.	6043.226
Date:	March 20, 2000
Supersedes:	NEW
Date:	NEW

ARMSTRONG

PARTS LIST

SERIES 4385

EQUAL SUCTION & DISCHARGE

VERTICAL IN-LINE

PACKING GLAND DESIGN

"M" DESIGNATION

1 1/4" IMPELLER BORE -- 1 3/4" I.D. PACKING

OLD DESIGN

MODEL 4385 - VERTICAL PUMP - PACKING GLAND DESIGN

GROUP NUMBER SELECTION CHART

MOTOR FRAME	143-145 JP	182-184 JP	213-215 JP	254-256 JP	284-286 JP	324-326 JP	364-365 JP	364-365 TY	404-405 TY
PUMP SIZE	GROUP NO.								
1 1/2D	S	S	M	M					
2D	S	S	M	M					
3D	S	S	M	M	M	M			
4D	S	S	M	M	M	M			
1 1/2E	S	S	M	M	M	M			
2E	S	S	M	M	M	M			
3E	S	S	M	M	M	M			
4E	S	S	M	M	M	M			
6F			M	M	M	M			
6FN			M	M	M	M			
8F			M	M	M	M			
8FN			M	M	M	M			
6G					M	M	L		
6GN					M	M	L		
8G					M	M	L	L	L
8GN					M	M	L	L	L

4385 GROUP NO.	S	M	L
PACKING I.D. SIZE SHAFT SLEEVE O.D.	1 1/4"	1-3/4"	2 1/8"
IMPELLER BORE	7/8"	1 1/4"	1 3/4"

CLOSE COUPLED / MOTOR MOUNTED

OLD STYLE VERTICAL PACKING GLAND DESIGN

MODEL 4385

SECTIONAL DRAWING

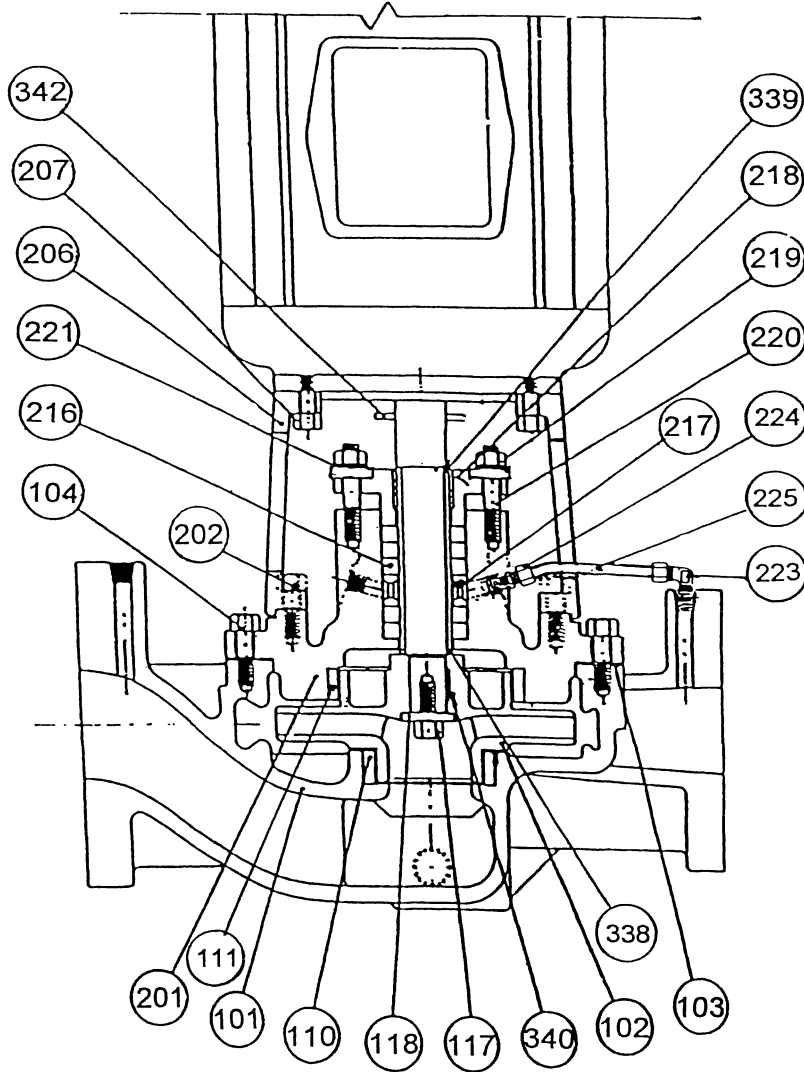

INDEX

ITEM NO.	DESCRIPTION	PAGE NO.	ITEM NO.	DESCRIPTION	PAGE NO.
101	VOLUTE	3, 4 & 5	218	GLAND PLATE	19, 20 & 21
102	IMPELLER	7, 8, 9 & 10	219	GLAND STUD NUT	19, 20 & 21
103	VOLUTE GASKET	6	220	GLAND STUD	19, 20 & 21
104	VOLUTE CAPSCREW & WASHER	26	221	GLAND STUD WASHER	19, 20 & 21
110	CASE WEAR RING (LOWER)	15 & 16	223	FLUSHLINE 90 DEG.ELBOW	27
111	WEAR RING (STUFFING BOX)	17 & 18	224	FLUSHLINE MALE CONNECTOR	27
117	IMPELLER CAPSCREW	19,20 & 21	225	FLUSHLINE TUBING	28
118	IMPELLER WASHER	19,20 & 21	338	SHAFT SLEEVE SPACER	22
201	STUFFING BOX COVER	11, 12 & 13	339	SHAFT SLEEVE	22
202	STUFF. BOX COVER CAPSCREW	25	340	IMPELLER KEY	19, 20 & 21
206	MOTOR/PUMP BRACKET	11, 12 & 13	342	WATER SLINGER	19, 20 & 21
207	MOTOR CAPSCREW	24	201/206	COMB. STUFF BOX & M/P BRKT.	14
216	GLAND PACKING	19, 20 & 21	not shown	SHAFT SLEEVE & SPACER KITS	23
217	LANTERN RING	19, 20 & 21			

CLOSE COUPLED / MOTOR MOUNTED PUMP PARTS

OLD STYLE VERTICAL PACKING GLAND DESIGN

MODEL 4385

ITEM 101 VOLUTE 125 LBS. A.S.A. FLANGES			
PUMP SIZE	MATERIAL	PART NUMBER	BAR CODE
1 1/2D	CAST IRON	425521-011	
1 1/2D	BRONZE	425521-041	
2D	CAST IRON	425523-011	
2D	BRONZE	425523-041	
3D	CAST IRON	425525-011	
3D	BRONZE	425525-041	
4D	CAST IRON	425527-011	
4D	BRONZE	425527-041	
1 1/2E	CAST IRON	425531-011	
1 1/2E	BRONZE	425531-041	
2E	CAST IRON	425533-011	
2E	BRONZE	425533-041	
3E	CAST IRON	425535-011	
3E	BRONZE	425535-041	
4E	CAST IRON	425537-011	
4E	BRONZE	425537-041	

VOLUTES CONTINUED ON PAGE 4

CLOSE COUPLED / MOTOR MOUNTED PUMP PARTS

OLD STYLE VERTICAL PACKING GLAND DESIGN

MODEL 4385

ITEM 101 VOLUTE 250 LBS. A.S.A. FLANGES			
PUMP SIZE	MATERIAL	PART NUMBER	BAR CODE
1 1/2D	CAST IRON	425522-011	
1 1/2D	BRONZE	425522-041	
2D	CAST IRON	425524-011	
2D	BRONZE	425524-041	
3D	CAST IRON	425526-011	
3D	BRONZE	425526-041	
4D	CAST IRON	425528-011	
4D	BRONZE	425528-041	
1 1/2E	CAST IRON	425532-011	
1 1/2E	BRONZE	425532-041	
2E	CAST IRON	425534-011	
2E	BRONZE	425534-041	
3E	CAST IRON	425536-011	
3E	BRONZE	425536-041	
4E	CAST IRON	425538-011	
4E	BRONZE	425538-041	

250 LB. VOLUTES CONTINUED ON PAGE 5

CLOSE COUPLED / MOTOR MOUNTED PUMP PARTS

OLD STYLE VERTICAL PACKING GLAND DESIGN

MODEL 4385

ITEM 101 VOLUTE 250 LBS. A.S.A. FLANGES

PUMP SIZE	MATERIAL	PART NUMBER	BAR CODE
6F	DUCTILE IRON	425620-031	
6FN	DUCTILE IRON	425620-031	
6G	DUCTILE IRON	425630-031	
6GN	DUCTILE IRON	425630-031	
8F	DUCTILE IRON	425720-031	
8FN	DUCTILE IRON	425720-031	
8G	DUCTILE IRON	425754-031	
8GN	DUCTILE IRON	425754-031	

CLOSE COUPLED / MOTOR MOUNTED PUMP PARTS

OLD STYLE VERTICAL PACKING GLAND DESIGN

MODEL 4385 "M" SIZE

ITEM 102 IMPELLER** 1 1/4" BORE

PUMP SIZE	MATERIAL	IMP. BORE	MAX. DIA.	PART NUMBER	BAR CODE
1 1/2 D	BRONZE	1 1/4"	7"	419229-041	
1 1/2 D	CAST IRON	1 1/4"	7"	419229-011	
2 D	BRONZE	1 1/4"	7"	419229-041	
2 D	CAST IRON	1 1/4"	7"	419229-011	
3 D	BRONZE	1 1/4"	7"	425530-041	
3 D	CAST IRON	1 1/4"	7"	425530-011	
4 D	BRONZE	1 1/4"	7"	419236-041	
4 D	CAST IRON	1 1/4"	7"	419236-011	
1 1/2 E	BRONZE	1 1/4"	9 1/2"	419238-041	
1 1/2 E	CAST IRON	1 1/4"	9 1/2"	419238-011	
2 E	BRONZE	1 1/4"	9 1/2"	419239-041	
2 E	CAST IRON	1 1/4"	9 1/2"	419239-011	
3 E	BRONZE	1 1/4"	9 1/2"	419241-041	
3 E	CAST IRON	1 1/4"	9 1/2"	419241-011	
4 E	BRONZE	1 1/4"	9 1/2"	425539-041	
4 E	CAST IRON	1 1/4"	9 1/2"	425539-011	

** Impeller Part Numbers are for full or maximum diameter Impellers. Always specify Pump Serial Number and where possible, measure and advise the diameter of the Impeller being replaced on these Pumps.

IMPELLERS CONTINUED ON PAGE 7

CLOSE COUPLED / MOTOR MOUNTED PUMP PARTS

OLD STYLE VERTICAL PACKING GLAND DESIGN

MODEL 4385 "M" SIZE

ITEM 102 IMPELLER** 1 1/4" BORE (Cont'd)

PUMP SIZE	MATERIAL	IMP. BORE	MAX. DIA.	PART NUMBER	BAR CODE
6F	BRONZE	1 1/4"	11"	425714-041	
6F	CAST IRON	1 1/4"	11"	425714-011	
6FN	BRONZE	1 1/4"	11"	425715-041	
6FN	CAST IRON	1 1/4"	11"	425715-011	
6G	BRONZE	1 1/4"	13"	425716-041	
6G	CAST IRON	1 1/4"	13"	425716-011	
6GN	BRONZE	1 1/4"	13"	425717-041	
6GN	CAST IRON	1 1/4"	13"	425717-011	
8F	BRONZE	1 1/4"	11"	425723-041	
8F	CAST IRON	1 1/4"	11"	425723-011	
8FN	BRONZE	1 1/4"	11"	425725-041	
8FN	CAST IRON	1 1/4"	11"	425725-011	
8G	BRONZE	1 1/4"	13"	425718-041	
8G	CAST IRON	1 1/4"	13"	425718-011	
8GN	BRONZE	1 1/4"	13"	425719-041	
8GN	CAST IRON	1 1/4"	13"	425719-011	

** Impeller Part Numbers are for full or maximum diameter Impellers. Always specify Pump Serial Number and where possible, measure and advise the diameter of the Impeller being replaced on these Pumps.

IMPELLERS CONTINUED ON PAGE 8

CLOSE COUPLED / MOTOR MOUNTED PUMP PARTS

OLD STYLE VERTICAL PACKING GLAND DESIGN

MODEL 4385 "L" SIZE

ITEM 102 IMPELLER** 1 5/8" BORE

PUMP SIZE	MATERIAL	IMP. BORE	MAX. DIA.	PART NUMBER	BAR CODE
8G	BRONZE	1 5/8"	13"	425735-041	
8G	CAST IRON	1 5/8"	13"	425735-011	
8GN	BRONZE	1 5/8"	13"	425736-041	
8GN	CAST IRON	1 5/8"	13"	425736-011	

** Impeller Part Numbers are for full or maximum diameter Impellers. Always specify Pump Serial Number and where possible, measure and advise the diameter of the Impeller being replaced on these Pumps.

CLOSE COUPLED / MOTOR MOUNTED PUMP PARTS

OLD STYLE VERTICAL PACKING GLAND DESIGN

MODEL 4385 GROUP 2

1 1/4" IMPELLER BORE---1 3/4" I.D. PACKING

ITEM 201 STUFFING BOX COVER					
PUMP SIZE	MOTOR FRAME	GROUP NO.	CONST.	PART NUMBER	BAR CODE
1 1/2D-4D	215CZ-256UCZ 213JP-215JP 254JP-256JP	M	B.F. & A.I.	419592-012	
1 1/2D-4D	215CZ-256UCZ 213JP-215JP 254JP-256JP	M	A.B.	419592-042	
1 1/2E-4E	215CZ-256UCZ 213JP-215JP 254JP-256JP	M	B.F. & A.I.	419593-012	
1 1/2E-4E	215CZ-256UCZ 213JP-215JP 254JP-256JP	M	A.B.	419593-042	

ITEM 206 MOTOR/PUMP BRACKET					
PUMP SIZE	MOTOR FRAME	GROUP NO.	CONST.	PART NUMBER	BAR CODE
1 1/2D-4D	215CZ-256UCZ 213JP-215JP 254JP-256JP	M	ALL	425464-011	
1 1/2E-4E	215CZ-256UCZ 213JP-215JP 254JP-256JP	M	ALL	425464-011	

NOTES:

- * B.F. Denotes "Bronze Fitted " construction. Parts in contact with pumped liquid are bronze or copper, except volute and cover plate.
- A.I. Denotes "All Iron " construction. Parts in contact with the pumped liquid are cast iron or steel, except shaft sleeve & mechanical seal.
- A.B. Denotes "All Bronze" construction. Parts in contact with the pumped liquid are bronze or stainless steel.

STUFFING BOX CONTINUED ON PAGE 10

CLOSE COUPLED / MOTOR MOUNTED PUMP PARTS

OLD STYLE VERTICAL PACKING GLAND DESIGN

MODEL 4385 GROUP 3

1 1/4" IMPELLER BORE---1 3/4" I.D. PACKING

ITEM 201 STUFFING BOX COVER					
PUMP SIZE	MOTOR FRAME SIZE	GROUP NO.	CONST.	PART NUMBER	BAR CODE
1 1/2D-4D	284UCZ-326UCZ 284JP-286JP 324JP-326JP	M	B.F. & A.I.	419592-012	
1 1/2D-4D	284UCZ-326UCZ 284JP-286JP 324JP-326JP	M	A.B.	419592-042	
1 1/2E-4E	284UCZ-326UCZ 284JP-286JP 324JP-326JP	M	B.F. & A.I.	419593-012	
1 1/2E-4E	284UCZ-326UCZ 284JP-286JP 324JP-326JP	M	B.F. & A.I.	419593-042	

ITEM 206 MOTOR/PUMP BRACKET					
PUMP SIZE	MOTOR FRAME SIZE	GROUP NO.	CONST.	PART NUMBER	BAR CODE
1 1/2D-4D	284UCZ-326UCZ 284JP-286JP 324JP-326JP	M	ALL	425076-011	
1 1/2E-4E	284UCZ-326UCZ 284JP-286JP 324JP-326JP	M	ALL	425076-011	

NOTES:

- * B.F. Denotes "Bronze Fitted " construction. Parts in contact with pumped liquid are bronze or copper, except volute and cover plate.
- A.I. Denotes "All Iron " construction. Parts in contact with the pumped liquid are cast iron or steel, except shaft sleeve & mechanical seal.
- A.B. Denotes "All Bronze" construction. Parts in contact with the pumped liquid are bronze or stainless steel.

STUFFING BOXES CONTINUED ON PAGE 11

CLOSE COUPLED / MOTOR MOUNTED PUMP PARTS

OLD STYLE VERTICAL PACKING GLAND DESIGN

MODEL 4385

ITEM 110 CASE WEAR RING (LOWER)			
PUMP SIZE	CONST.	PART NUMBER	BAR CODE
1 1/2D	B.F. & A.B.	425550-041	
1 1/2D	A.I.	425550-071	
2D	B.F. & A.B.	425550-041	
2D	A.I.	425550-071	
3D	B.F. & A.B.	425550-045	
3D	A.I.	425550-075	
4D	B.F. & A.B.	425550-045	
4D	A.I.	425550-075	
1 1/2E	B.F. & A.B.	425550-041	
1 1/2E	A.I.	425550-071	
2E	B.F. & A.B.	425550-043	
2E	A.I.	425550-073	
3E	B.F. & A.B.	425550-045	
3E	A.I.	425550-075	
4E	B.F. & A.B.	425550-047	
4E	A.I.	425550-077	

NOTES:

* B.F. Denotes "Bronze Fitted " construction. Parts in contact with pumped liquid are bronze or copper, except volute and cover plate.

A.I. Denotes "All Iron " construction. Parts in contact with the pumped liquid are cast iron or steel, except shaft sleeve & mechanical seal.

A.B. Denotes "All Bronze" construction. Parts in contact with the pumped liquid are bronze or stainless steel.

CASE WEAR RINGS (LOWER) CONTINUED ON PAGE 12

CLOSE COUPLED / MOTOR MOUNTED PUMP PARTS

OLD STYLE VERTICAL PACKING GLAND DESIGN

MODEL 4385

ITEM 110 CASE WEAR RING (LOWER)			
PUMP SIZE	CONST.	PART NUMBER	BAR CODE
6F & 6FN	B.F. & A.B.	425550-055	
6F & 6FN	A.I.	425550-085	
6G & 6GN	B.F. & A.B.	425550-057	
6G & 6GN	A.I.	425550-087	
8F & 8FN	B.F. & A.B.	425550-057	
8F & 8FN	A.I.	425550-087	
8G & 8GN	B.F. & A.B.	425550-059	
8G & 8GN	A.I.	425550-089	

NOTES:

- * B.F. Denotes "Bronze Fitted " construction. Parts in contact with pumped liquid are bronze or copper, except volute and cover plate.
- A.I. Denotes "All Iron " construction. Parts in contact with the pumped liquid are cast iron or steel, except shaft sleeve & mechanical seal.
- A.B. Denotes "All Bronze" construction. Parts in contact with the pumped liquid are bronze or stainless steel.

CASE WEAR RINGS (STUFFING BOX) ON PAGE 17 & 18

CLOSE COUPLED / MOTOR MOUNTED PUMP PARTS

OLD STYLE VERTICAL PACKING GLAND DESIGN

MODEL 4385

ITEM 111 CASE WEAR RING (STUFFING BOX)			
PUMP SIZE SIZE	CONST.	PART NUMBER	BAR CODE
1 1/2D	B.F. & A.B.	425550-049	
1 1/2D	A.I.	425550-079	
2D	B.F. & A.B.	425550-049	
2D	A.I.	425550-079	
3D	B.F. & A.B.	425550-049	
3D	A.I.	425550-079	
4D	B.F. & A.B.	425550-049	
4D	A.I.	425550-079	
1 1/2E	B.F. & A.B.	425550-051	
1 1/2E	A.I.	425550-081	
2E	B.F. & A.B.	425550-051	
2E	A.I.	425550-081	
3E	B.F. & A.B.	425550-051	
3E	A.I.	425550-081	
4E	B.F. & A.B.	425550-051	
4E	A.I.	425550-081	

NOTES:

* B.F. Denotes "Bronze Fitted " construction. Parts in contact with pumped liquid are bronze or copper, except volute and cover plate.

A.I. Denotes "All Iron " construction. Parts in contact with the pumped liquid are cast iron or steel, except shaft sleeve & mechanical seal.

A.B. Denotes "All Bronze" construction. Parts in contact with the pumped liquid are bronze or stainless steel.

CASE WEAR RINGS (STUFFING BOX) CONTINUED ON PAGE 14

CLOSE COUPLED / MOTOR MOUNTED PUMP PARTS

OLD STYLE VERTICAL PACKING GLAND DESIGN

MODEL 4385

ITEM 111 CASE WEAR RING (STUFFING BOX)			
PUMP SIZE SIZE	CONST.	PART NUMBER	BAR CODE
6F & 6FN	B.F. & A.B.	425550-051	
6F & 6FN	A.I.	425550-081	
6G & 6GN	B.F. & A.B.	425550-053	
6G & 6GN	A.I.	425550-083	
8F & 8FN	B.F. & A.B.	425550-051	
8F & 8FN	A.I.	425550-081	
8G & 8GN	B.F. & A.B.	425550-053	
8G & 8GN	A.I.	425550-083	

NOTES:

- * B.F. Denotes "Bronze Fitted " construction. Parts in contact with pumped liquid are bronze or copper, except volute and cover plate.
- A.I. Denotes "All Iron " construction. Parts in contact with the pumped liquid are cast iron or steel, except shaft sleeve & mechanical seal.
- A.B. Denotes "All Bronze" construction. Parts in contact with the pumped liquid are bronze or stainless steel.

CLOSE COUPLED / MOTOR MOUNTED PUMP PARTS

OLD STYLE VERTICAL PACKING GLAND DESIGN

MODEL 4385 "M" SIZE

1 1/4" IMPELLER BORE---1 5/8" I.D. PACKING

COMMON PARTS			
ITEM NO.	DESCRIPTION	PART NUMBER	BAR CODE
117	IMPELLER CAPSCREW S/S	911900-113	
118	IMPELLER WASHER B.F./A.I./A.B.*	425742-003	
216	GLAND PACKING (5 RINGS REQ'D)	966301-007	
217	LANTERN RING B.F. & A.B.*	419596-041	
217	LANTERN RING A.I.*	419596-011	
218	GLAND B.F. & A.B.*	419595-041	
218	GLAND A.I.*	419595-011	
219	GLAND STUD (2 REQ'D) 3/8"NC X 2 3/8" S/S	915221-420	
220	GLAND NUT (2 REQ'D) 3/8"NC S/S	913121-400	
221	GLAND STUD WASHER (2 REQ'D) 3/8" S/S	927114-000	
340	IMPELLER KEY 1/4" SQ. X 1 3/4" LG.	428161-114	
342	WATER SLINGER	411343-000	

NOTES:

* B.F. Denotes "Bronze Fitted " construction. Parts in contact with pumped liquid are bronze or copper, except volute and cover plate.

A.I. Denotes "All Iron" construction. Parts in contact with the pumped liquid are cast iron or steel, except shaft sleeve & mechanical seal.

A.B. Denotes "All Bronze" construction. Parts in contact with the pumped liquid are bronze or stainless steel.

CLOSE COUPLED / MOTOR MOUNTED PUMP PARTS

OLD STYLE VERTICAL PACKING GLAND DESIGN

MODEL 4385 "M" Size

1 1/4" IMPELLER BORE---1 5/8" I.D. PACKING

ITEM 339 SHAFT SLEEVE

GROUP No.	SLEEVE O.D.	CONST.	PART NUMBER	BAR CODE
M	1 5/8"	A.B. - B.F.	425869-023	
M	1 5/8"	A.I.	425869-024	

SHAFT SLEEVE SPACER

GROUP NO.	SLEEVE O.D.	CONST.	PART NUMBER	BAR CODE
2 & 3	1 5/8"	A.B. - B.F. - A.I.	425868-002	

ITEM 103 VOLUTE "O" RING

PUMP SIZE	CONST.	PART NUMBER	BAR CODE
6F, 6FN, 8F & 8FN	ALL	961131-451	
6G, 6GN 8G & 8GN	ALL	961131-455	

NOTES*

- * B.F. Denotes "Bronze Fitted " construction. Parts in contact with pumped liquid are bronze or copper, except volute and cover plate.
- A.I. Denotes "All Iron" construction. Parts in contact with the pumped liquid are cast iron or steel, except shaft sleeve & mechanical seal.
- A.B. Denotes "All Bronze" construction. Parts in contact with the pumped liquid are bronze or stainless steel.

SHAFT SLEEVE KITS ON PAGE 17

CLOSE COUPLED / MOTOR MOUNTED PUMP PARTS

OLD STYLE VERTICAL PACKING GLAND DESIGN

MODEL 4385 "M" SIZE

1 1/4" IMPELLER BORE---1 5/8" I.D. PACKING

SHAFT SLEEVE & SPACER KITS

GROUP NO.	SLEEVE O.D.	CONST.	PART NUMBER	BAR CODE
M	1 5/8"	A.B. - B.F.	835085-007	
M	1 5/8"	A.I.	835085-008	

NOTES:

* B.F. Denotes "Bronze Fitted " construction. Parts in contact with pumped liquid are bronze or copper, except volute and cover plate.

A.I. Denotes "All Iron" construction. Parts in contact with the pumped liquid are cast iron or steel, except shaft sleeve & mechanical seal.

A.B. Denotes "All Bronze" construction. Parts in contact with the pumped liquid are bronze or stainless steel.

CLOSE COUPLED / MOTOR MOUNTED PUMP PARTS

OLD STYLE VERTICAL PACKING GLAND DESIGN

MODEL 4385 "M" SIZE

1 1/4" IMPELLER BORE---1 5/8" I.D. PACKING

SHAFT SLEEVE & SPACER KITS

GROUP NO.	SLEEVE O.D.	CONST.	PART NUMBER	BAR CODE
M	1 5/8"	A.B. - B.F.	835085-007	
M	1 5/8"	A.I.	835085-008	

NOTES:

* B.F. Denotes "Bronze Fitted " construction. Parts in contact with pumped liquid are bronze or copper, except volute and cover plate.
 A.I. Denotes "All Iron" construction. Parts in contact with the pumped liquid are cast iron or steel, except shaft sleeve & mechanical seal.
 A.B. Denotes "All Bronze" construction. Parts in contact with the pumped liquid are bronze or stainless steel.

ITEM 207 MOTOR CAPSCREW

MOTOR FRAME SIZE	CAPSCREW SIZE	NO. REQ'D	PART NUMBER	BAR CODE
213C-256UC 213JM-215JM 213JP-215JP 254TCZ-256TCZ 254JP-256JP 284UC-286UC 284TCZ-286TCZ 284JM-286JM	1/2-13NCX1 1/4"	4	911125-110	
284JP-286JP 324UC-405USC 324TCZ-326TCZ 324JP-326JP	5/8-11NCX1 1/4"	4	911129-112	

MOTOR CAPSCREW LOCKWASHER

MOTOR FRAME SIZE	LOCKWASHER SIZE	NO. REQ'D	PART NUMBER	BAR CODE
284JP TO 405TY	5/8"	4	927215-100	

CLOSE COUPLED / MOTOR MOUNTED PUMP PARTS

OLD STYLE VERTICAL PACKING GLAND DESIGN

MODEL 4385

ITEM 104 VOLUTE CAPSCREW					
FRAME SIZE	PUMP SIZE	SIZE	NO. REQ'D	PART NUMBER	BAR CODE
143JP TO 256JP	1 1/4D TO 4D	3/8-16NCX1"	8	911121-108	
284JP TO 326JP	3D AND 4D	3/8-16NCX2 5/8"	8	911121-120	
143JP TO 326JP	1 1/2E TO 4E	3/8-16NCX1"	12	911121-108	
213JP TO 326JP	6F TO 8FN	1/2-13NCX1 1/4"	12	911125-310	
364JP TO 365JP 404TY TO 405TY	6G TO 6GN	1/2-16NCX1 1/4"	18	911125-310	

VOLUTE CAPSCREW LOCKWASHER					
FRAME SIZE	PUMP SIZE	SIZE	NO. REQ'D	PART NUMBER	BAR CODE
143JP TO 326JP	1 1/4D TO 4D	7/16"	8	927212-100	
143JP TO 326JP	1 1/2E TO 4E	7/16"	12	927212-100	
213JP TO 326JP	6F TO 8FN	1/2"	12	927213-100	
364JP TO 365JP 404TY TO 405TY	6G TO 6GN	1/2"	18	927213-100	

CLOSE COUPLED / MOTOR MOUNTED PUMP PARTS

OLD STYLE VERTICAL PACKING GLAND DESIGN

MODEL 4385

ITEM 223 MALE ELBOW *						
PUMP SIZE	NO. REQ'D	MAT'L	SIZE	CONST.	PART NUMBER	BAR CODE
ALL	1	BRASS	3/8" TUBE X 1/4" NPT	B.F. & A.B.	939003-109	
ALL	1	STEEL	3/8" TUBE X 1/4" NPT	A.I.	939003-209	

ITEM 224 MALE CONNECTOR *						
PUMP SIZE	NO. REQ'D	MAT'L	SIZE	CONST.	PART NUMBER	BAR CODE
ALL	1	BRASS	3/8" TUBE X 1/4" NPT	B.F. & A.B.	939001-114	
ALL	1	STEEL	3/8" TUBE X 1/4" NPT	A.I.	939001-214	

NOTES:

* PUMPS ORIGINALLY SUPPLIED WITH 1/4" TUBING FLUSH LINES, WHEN REPLACING FLUSH LINES OR COMPONENTS CHANGE TUBING AND FITTINGS TO 3/8" PER ABOVE PARTS LIST.

** B.F. Denotes "Bronze Fitted " construction. Parts in contact with pumped liquid are bronze or copper, except volute and cover plate.

A.I. Denotes "All Iron " construction. Parts in contact with the pumped liquid are cast iron or steel, except shaft sleeve & mechanical seal.

A.B. Denotes "All Bronze" construction. Parts in contact with the pumped liquid are bronze or stainless steel.

CLOSE COUPLED / MOTOR MOUNTED PUMP PARTS

OLD STYLE VERTICAL PACKING GLAND DESIGN

MODEL 4385

ITEM 225 FLUSH LINE TUBING**						
PUMP SIZE	TUBING SIZE	NO. REQ'D	LENGTH	CONST.	PART NUMBER	BAR CODE
1 1/2D TO 4D AND 1 1/2E TO 4E	3/8" OD	1	12"LG.	B.F. - A.B.	997531-004	
				A.I.	997153-004	
4GN 6F TO 6FN 6G TO 6GN	3/8" OD	1	16"LG.	B.F. - A.B.	997531-004	
				A.I.	997153-004	
8F TO 8FN AND 8G TO 8GN	3/8" OD	1	24"LG.	B.F. - A.B.	997531-004	
				A.I.	997153-004	

NOTES:

* B.F. Denotes "Bronze Fitted " construction. Parts in contact with pumped liquid are bronze or copper, except volute and cover plate.

A.I. Denotes "All Iron " construction. Parts in contact with the pumped liquid are cast iron or steel, except shaft sleeve & mechanical seal.

A.B. Denotes "All Bronze" construction. Parts in contact with the pumped liquid are bronze or stainless steel.

**** PUMPS ORIGINALLY SUPPLIED WITH 1/4" TUBING FLUSH LINES, WHEN REPLACING FLUSH LINES OR COMPONENTS CHANGE TUBING AND FITTINGS TO 3/8" PER ABOVE PARTS LIST.**